

Proposed Plan
Scale 1:50

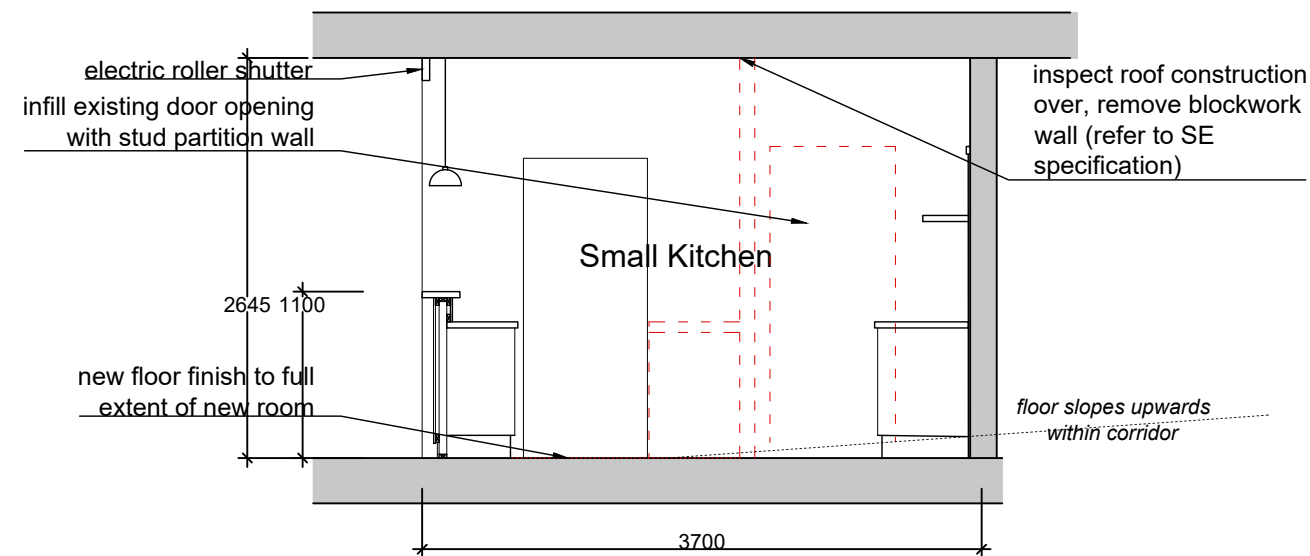

Proposed Section BB
Scale 1:50

Proposal

Alterations:

- infill existing door opening
- dismantle wall between bar and store room behind to create an enlarged bar area
- make good floor and allow for Altro vinyl floor finish

Finishes:

- front of bar finished in T&G vertical paneling in off white paint finish to match the paneling within the existing main hall
- bar to include; commercial stainless steel sink unit with hot water heater

Electrical Legend

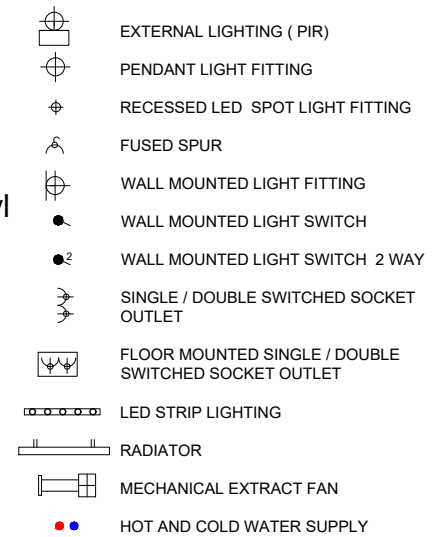

Do not scale from this drawing for construction. Figured dimensions only to be taken. Check all dimensions prior to setting out. Report all discrepancies to the Architect.

Revisions

TENDER

Robin Nugent Architects
Chartered Architects ©
Castle Barn Sedgwick Horsham
West Sussex RH13 6QJ

T: 01403 734858 F: 01403 738368
E: robin@robinnugentarchitects.co.uk
W: www.robinnugentarchitects.co.uk

Client:
Mrs Beverley Ball

Project:
Cranleigh Village Hall, Village Way,
Cranleigh, GU6 8AF

Phase I Refurbishment

Drawing Title:
Proposed Small Kitchen Plan and
Sections

Scale: 1:50 **Date:** Feb24 **Drawn by:** JD

Drawing No: 24865/213 **Revision:** -

< Original size 60mm - A3 at full size >

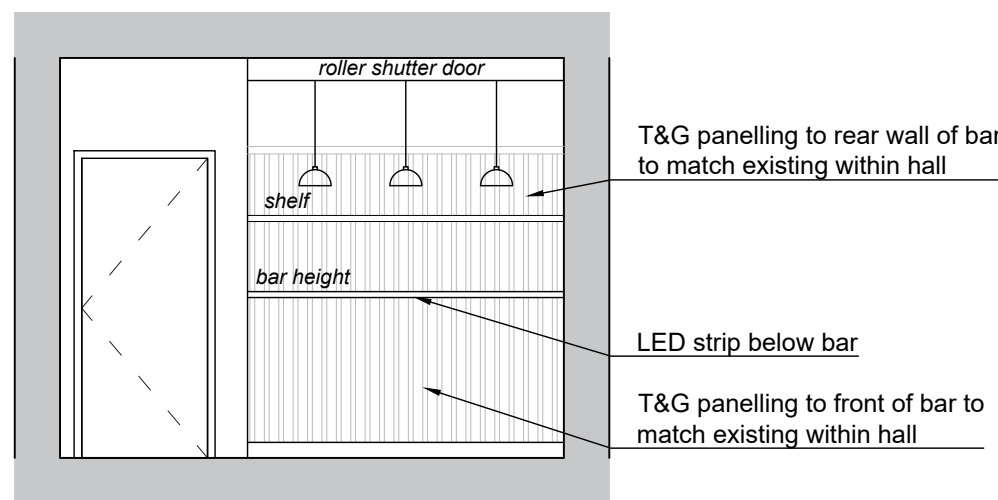

Proposed Section EE
Scale 1:50

